

Freestanding Play
(5-12 years)
Max Fall Height: 18 inches

TOTAL ELEVATED PLAY COMPONENTS	0		
TOTAL ELEVATED COMPONENTS ACCESSIBLE BY RAMP	0	REQUIRED	0
TOTAL ELEVATED COMPONENTS ACCESSIBLE BY TRANSFER	0	REQUIRED	0
TOTAL ACCESSIBLE GROUND LEVEL COMPONENTS SHOWN	1	REQUIRED	0
TOTAL DIFFERENT TYPES OF GROUND LEVEL COMPONENTS	1	REQUIRED	1

TOTAL SQUARE FOOTAGE
400 SQ FT

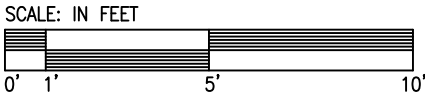

295695 ReviWheel Spinner

Landscape
Structures

SYSTEM TYPE:
FreeStanding

DRAWING #:
295695



landscape
structures



The play components identified on this plan are IPEMA certified. (Unless model number is preceded with *) The use and layout of these components conform to the requirements of ASTM F1487. To verify product certification, visit www.ipema.org

THIS PLAY AREA & PLAY EQUIPMENT IS DESIGNED FOR AGES 5-12 YEARS UNLESS OTHERWISE NOTED ON PLAN.

IT IS THE MANUFACTURERS OPINION THAT THIS PLAY AREA DOES CONFORM TO THE A.D.A. ACCESSIBILITY STANDARDS, ASSUMING AN ACCESSIBLE PROTECTIVE SURFACING IS PROVIDED, AS INDICATED, OR WITHIN THE ENTIRE USE ZONE.

THIS CONCEPTUAL PLAN WAS BASED ON INFORMATION AVAILABLE TO US. PRIOR TO CONSTRUCTION, DETAILED SITE INFORMATION INCLUDING SITE DIMENSIONS, TOPOGRAPHY, EXISTING UTILITIES, SOIL CONDITIONS, AND DRAINAGE SOLUTIONS SHOULD BE OBTAINED, EVALUATED, & UTILIZED IN THE FINAL DESIGN. PLEASE VERIFY ALL DIMENSIONS OF PLAY AREA, SIZE, ORIENTATION, AND LOCATION OF ALL EXISTING UTILITIES, EQUIPMENT, AND SITE FURNISHINGS PRIOR TO ORDERING. SLIDES SHOULD NOT FACE THE HOT AFTERNOON SUN.

CHOOSE A PROTECTIVE SURFACING MATERIAL THAT HAS A CRITICAL HEIGHT VALUE TO MEET THE MAXIMUM FALL HEIGHT FOR THE EQUIPMENT (REF. ASTM F1487 STANDARD CONSUMER SAFETY PERFORMANCE SPECIFICATION FOR PLAYGROUND EQUIPMENT FOR PUBLIC USE, SECTION 8 CURRENT REVISION). THE SUBSURFACE MUST BE WELL DRAINED. IF THE SOIL DOES NOT DRAIN NATURALLY IT MUST BE TILED OR SLOPED 1/8" TO 1/4" PER FOOT TO A STORM SEWER OR A "FRENCH DRAIN".

DESIGNED BY:

COPYRIGHT: 12/8/21
LANDSCAPE STRUCTURES, INC.
601 7th STREET SOUTH - P.O. BOX 198
DELANO, MINNESOTA 55328
PH: 1-800-328-0035 FAX: 1-763-972-6091

Date	Previous Drawing #	Initials
------	--------------------	----------

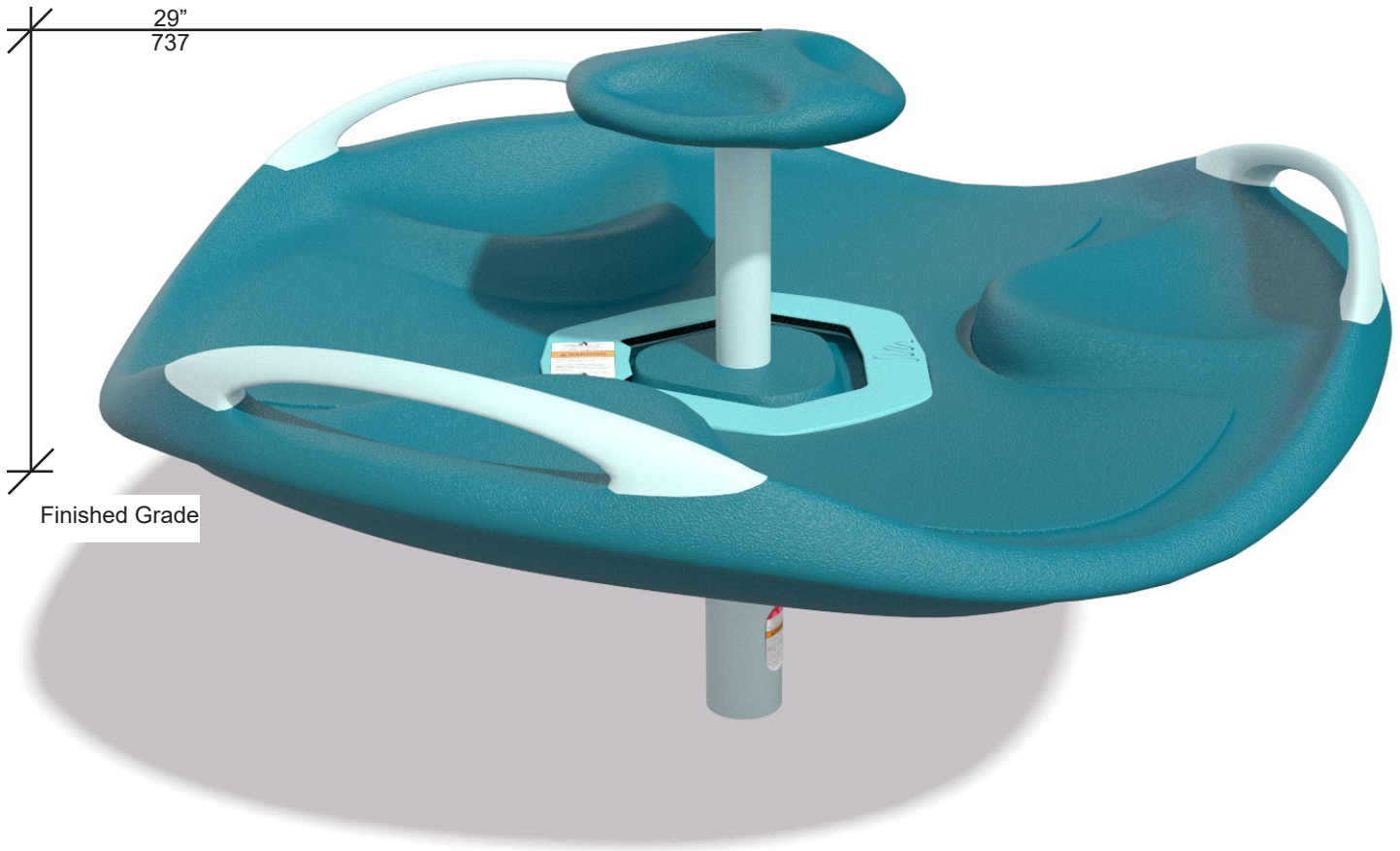

DETAIL LAYOUT

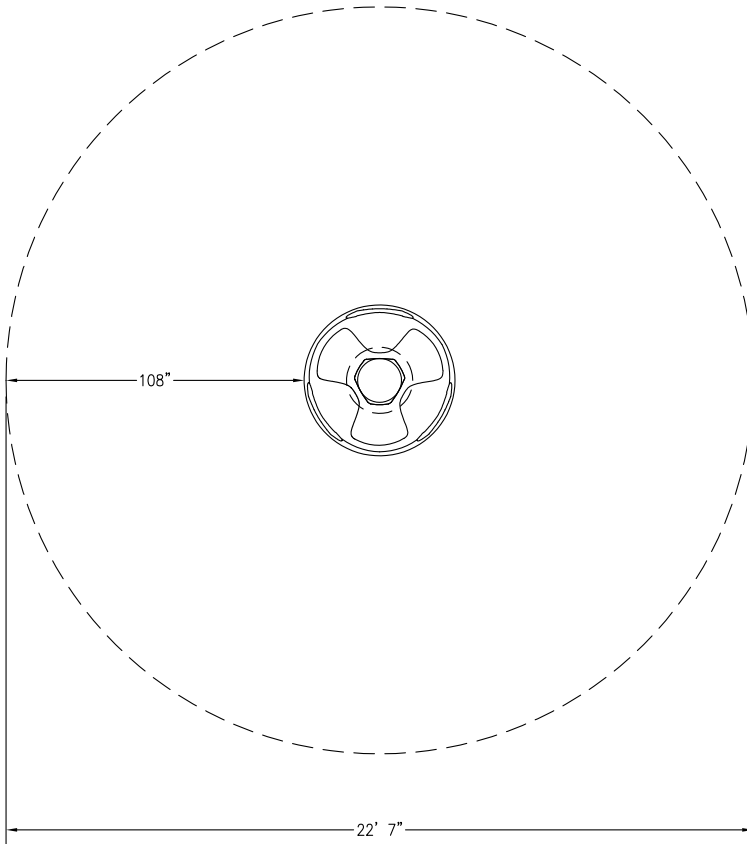

DETAIL DIRECT BURY

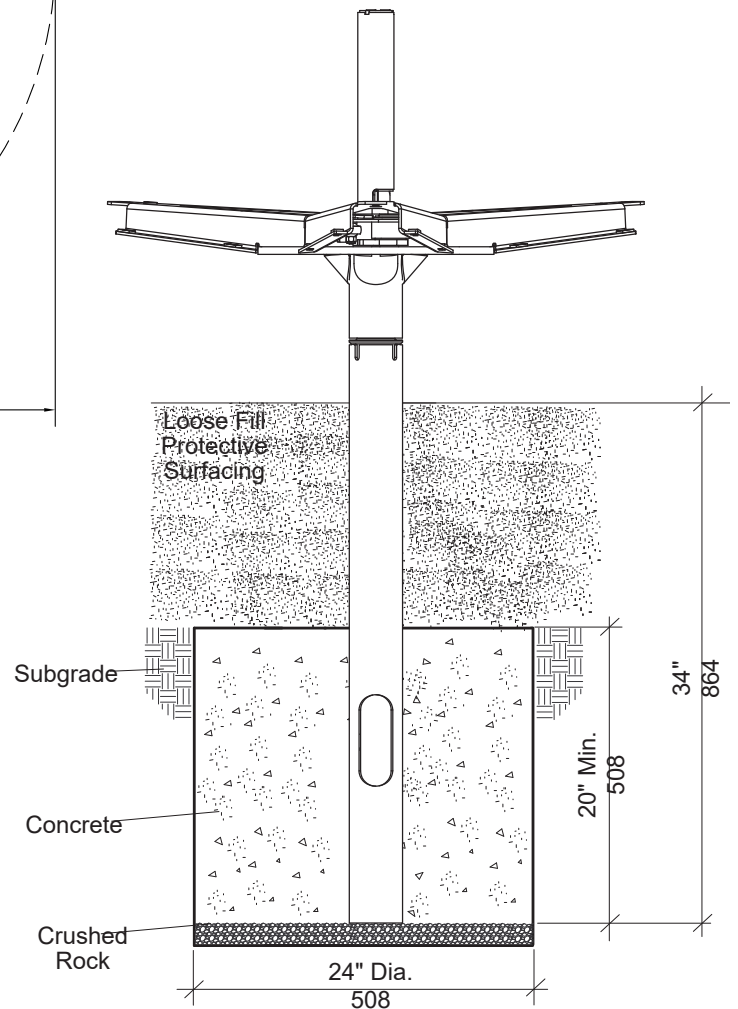

Top ring assembly

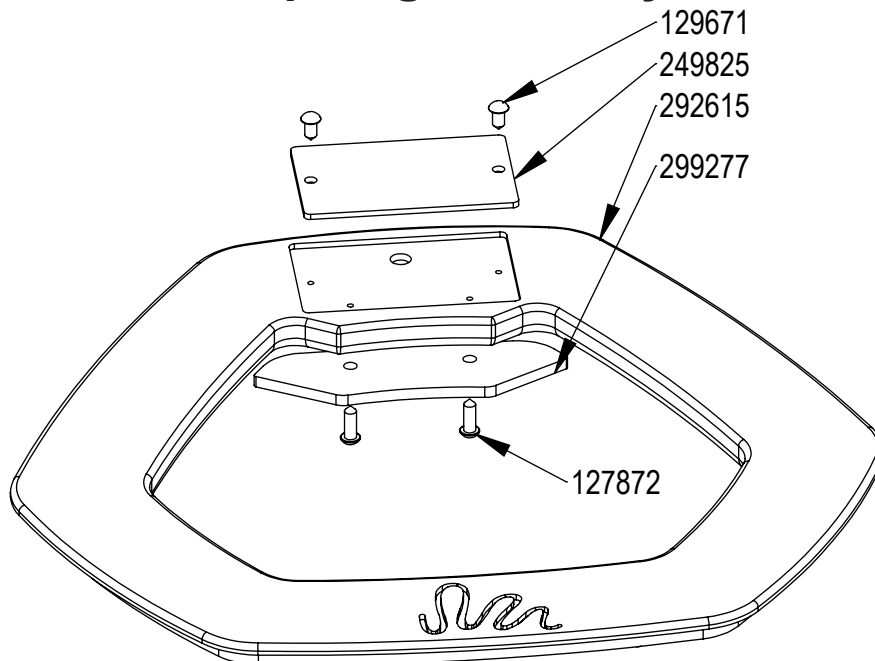

* Part#	Description	Qty.
292615	SPINNER HAND HOLD PERM	1
299277	HANDLE SPACER	1
127872	BHCS TORX #14 x 3/4 SST THREAD TYPE AB	2
129671	BHCS TORX #14 x 1/2 SST	2
249825	5-12 YRS Play Safe Warning Plate Flat Small	1

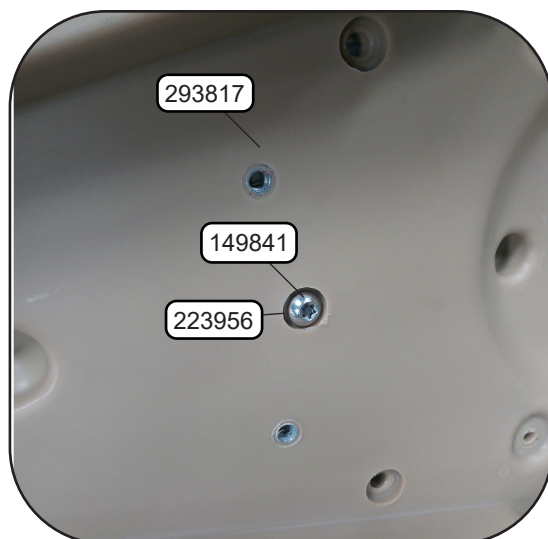

Find the hardware location for the permalene ring.
The first location is between the two inserts

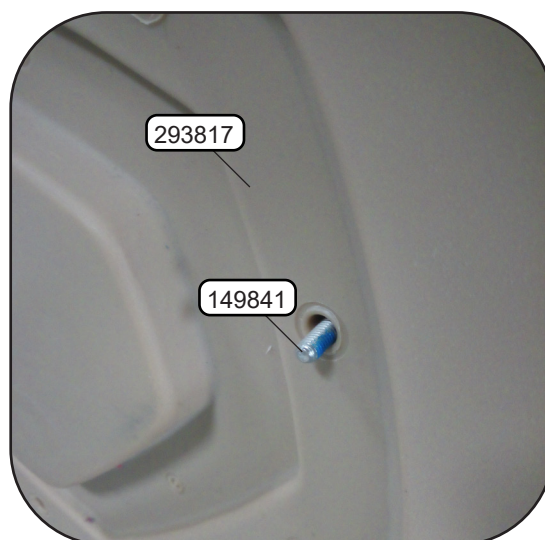

Hardware for the permalene ring goes through the rotomold

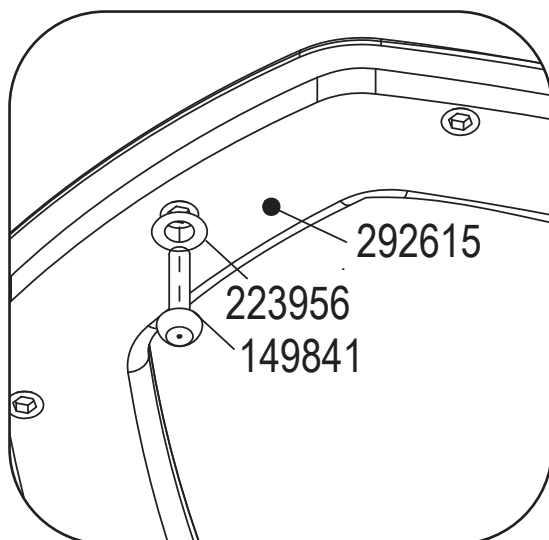

Hardware and insert connection

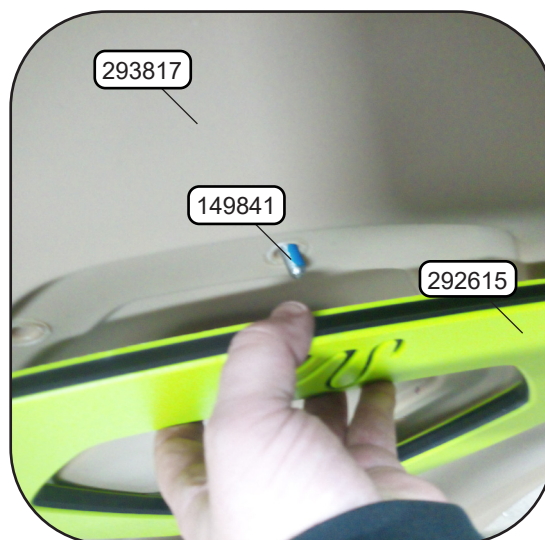

Attach the the hardware to the inserts fastened to the permalene ring

**IMPORTANT! Do not use impact driver on 5/16" x 3/4" BHCS w/Pin.
Torque 5ft-lbs maximum.**

* Part#	Description	Qty.
293817	REVIWHEEL SPINNER W/ CNTR HOLE	1
149841	BHCS 6LP 5/16x1-1/2i SST WITH TORQ-PATCH	9
223956	WASHER FLAT SAE 5/16i SST	9



Hardware under from underneath the rotomold



Handle installation

* Part#	Description	Qty.
292820	REVI SPINNER HANDLE PNT	3
123224	BHCS 6LP 3/8x1-11/16i SST	12
100365	WASHER FLAT SAE 3/8i SST	12

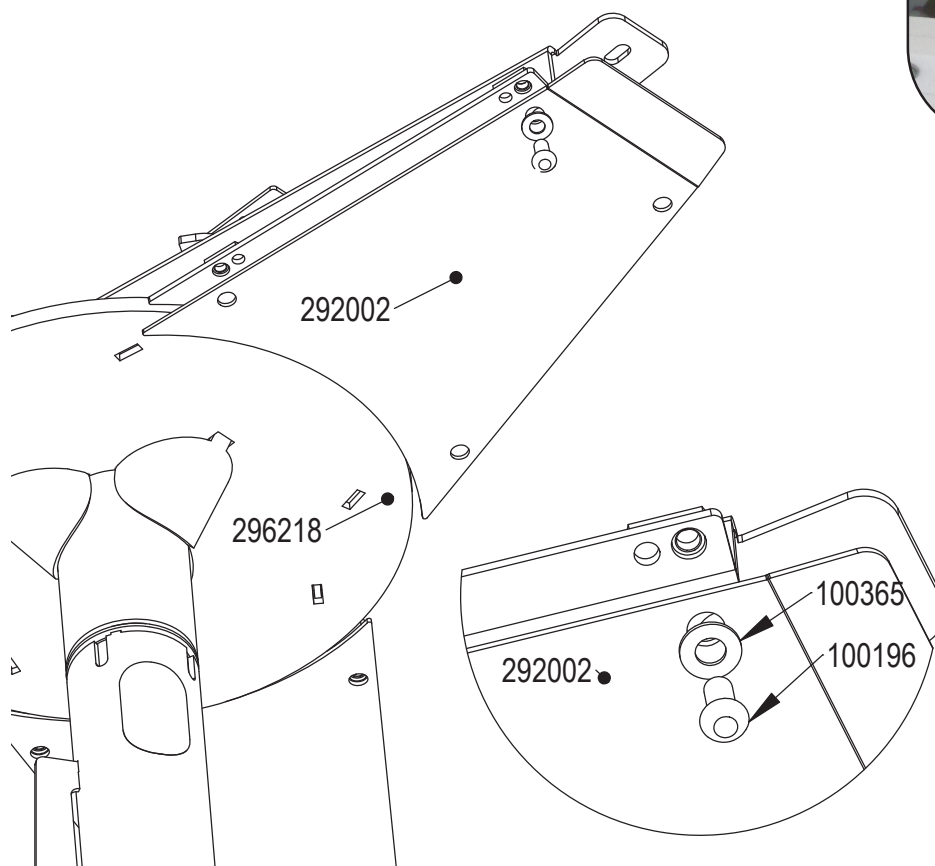
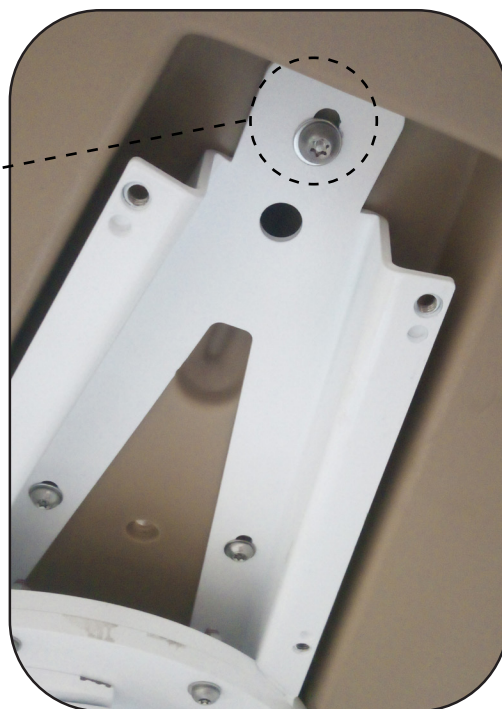
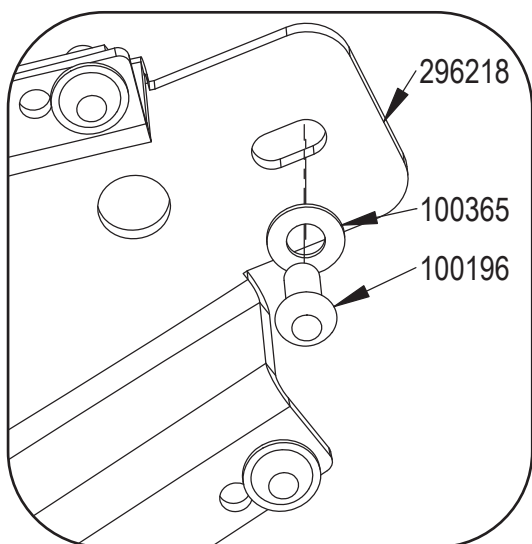

* Part#	Description	Qty.
292002	SPINNER BOTTOM COVER	3
296218	REVIWHEEL SPINNER BASE ASSEMBLY	1
100196	BHCS 6LP 3/8x7/8i SST	21
100365	WASHER FLAT SAE 3/8i SST	21

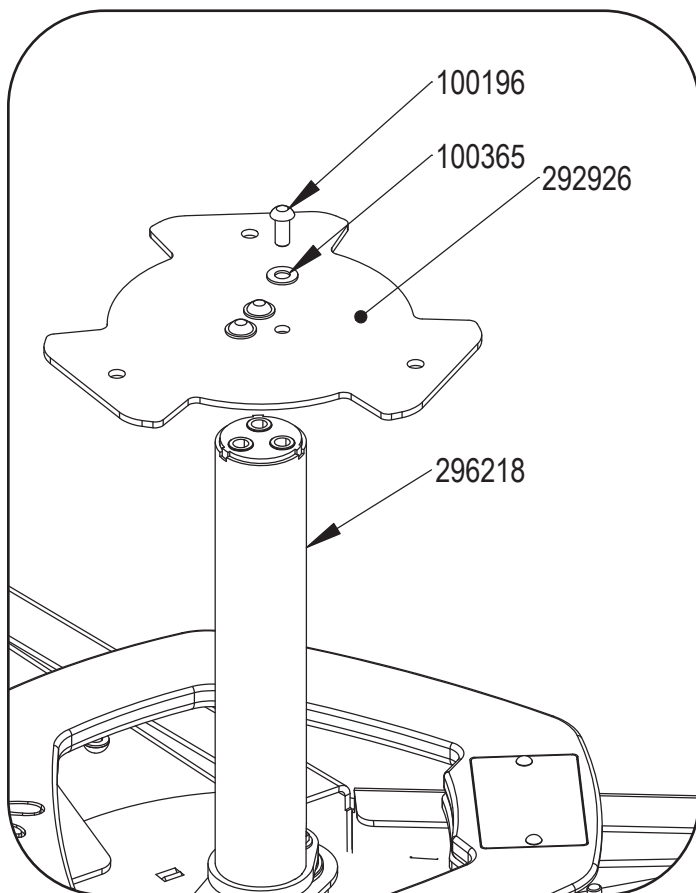

Attach the Plate to the base FIRST

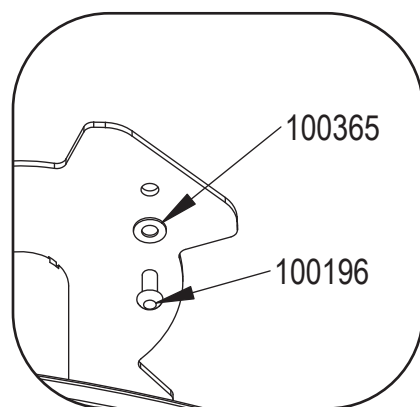

Attach the Roto to the base SECOND

* Part#	Description	Qty.
292926	SPINNER TOP PLATE	1
294244	REVIWHEEL HANDLE ROTOMOLD	1
100196	BHCS 6LP 3/8x7/8i SST	6
100365	WASHER FLAT SAE 3/8i SST	6

Parts List

Part#	Description	Qty.
292002	SPINNER BOTTOM COVER	3
292615	SPINNER HAND HOLD PERM	1
292820	REVI SPINNER HANDLE PNT	3
292926	SPINNER TOP PLATE	1
293817	REVIWHEEL SPINNER W/ CNTR HOLE	1
294244	REVIWHEEL HANDLE ROTOMOLD	1
296218	REVIWHEEL SPINNER BASE ASSEMBLY	1
299277	HANDLE SPACER	1
296197	Hdw Pkg ReviWheel™ Spinner	1
100196	BHCS 6LP 3/8x7/8i SST	27
100365	WASHER FLAT SAE 3/8i SST	39
123224	BHCS 6LP 3/8x1-11/16i SST	12
127463	BIT HEX TPP T27 (TORX)	1
127872	BHCS TORX #14 x 3/4 SST THREAD TYPE AB	2
129671	BHCS TORX #14 x 1/2 SST	2
149841	BHCS 6LP 5/16x1-1/2i SST WITH TORQ-PATCH	9
255617	WASHER FLAT SAE 5/16i SST	9
249825	5-12 YRS PLAY SAFE WARNING PLATE FLAT SMALL	1

Specifications

Bearing:	2" (50 mm) Deep groove stainless steel.
Fasteners:	Primary fasteners shall be socketed and pinned tamper-proof in design, stainless steel (SST) per ASTM F 879 unless otherwise indicated (see specific product installation/specifications).
Revi Roto:	Rotationally molded from U.V. stabilized linear low-density polyethylene, color specified.
Permalene:	3/4" Thick HDPE Permalene, Specify color.
Hand Hold:	Fabricated from A356 sand casted aluminum. Finish: ProShield®, Specify color.
Spinner Support:	(Post) Weldment comprised of 3.500" (88,9 mm) O.D. RS20 (.125") (3,17 mm) wall galvanized steel tubing, 1/8" (3,17 mm) thick HRPO steel plate and 1.967" (49,96 mm) O.D. steel shaft. (Base) Weldment comprised of 3/8" (9,6 mm) HRPO sheet steel and 3/16" (4,8 mm) HRPO sheet steel. (Shock Covers) 16 GA (.060") HRPO sheet steel. (Crank Arms & Pins) Fabricated from stainless steel. (Shocks) Gas shocks with fixed bearings. Finish: ProShield®, specify color.
Installation Time:	DB - Approx. 6 person hours
Concrete Req.:	DB - Approx. 5.23 cu. ft.
Weight:	DB - 177 lbs.
Minimum Area	
Req.:	22'7" diameter (9' use zone / 6' nonoverlapping)
Fall Height:	DB - 18" (.45 m)